



LE NID

Design by
IDEATO.
DESIGN & CONSTRUCTIONS

 **LE NID**

All renders/images shown are for illustrative purposes only.



All renders/images shown are for illustrative purposes only.

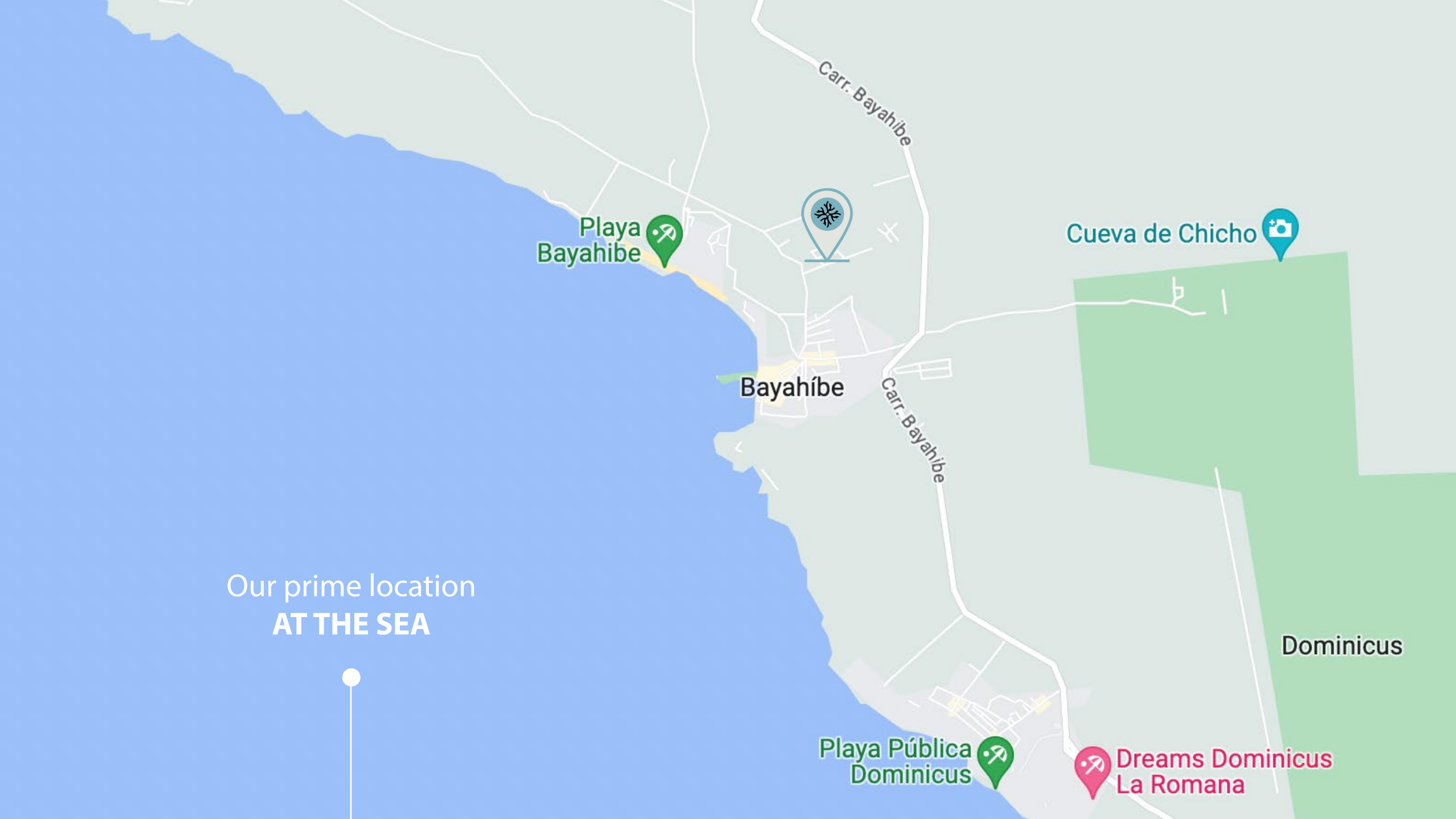

Our prime location
AT THE SEA



Playa Bayahibe

Bayahibe

Cueva de Chicho

Dominicus

Playa Pública Dominicanus

Dreams Dominicanus La Romana



ART AND ARCHITECTURE

The architect has materialized a vision in which art and architecture intertwine in an essential way.

This bold approach was carried out without aesthetic or conceptual limitations, achieving **harmony** between livability and the singularity of an unmistakable design.



All renders/images shown are for illustrative purposes only.



THE BUILDING

Le Nid's design is presented as a work that dialogues with its natural surroundings, with Bayahibe being the **idyllic location**.

From the facade, the large windows open outward, seeking the characteristic white light of Bayahibe.



All renders/images shown are for illustrative purposes only.



LE NID

All renders/images shown are for illustrative purposes only.



This choice not only maximizes the entry of natural light but also establishes a constant visual connection with the surrounding landscape.

YOUR PLACE ❄️ *IN THE BEST DESTINATION*





All renders/images shown are for illustrative purposes only.



All renders/images shown are for illustrative purposes only.



LE NID



Alvaro Siza In/discipline
EAT DRINK NAP



All renders/images shown are for illustrative purposes only.



Harmony between **SPACE AND NATURE**

Upon entering the interior space, the large windows not only offer panoramic views but also frame and define the surroundings, integrating them as another constructive element.

This fusion between interior and exterior creates a welcoming and relaxing atmosphere, **where nature becomes part of the home.**



DELIGHT YOUR SENSES

Enjoy stunning views of the mountain and the sea from the serene pool and the classy amenities.

The **exclusive** resort-style living comes to you.

Piscina

Gazebo

Music atmosphere

Gym

White line

Entry gate with 24-hour security

Grill area

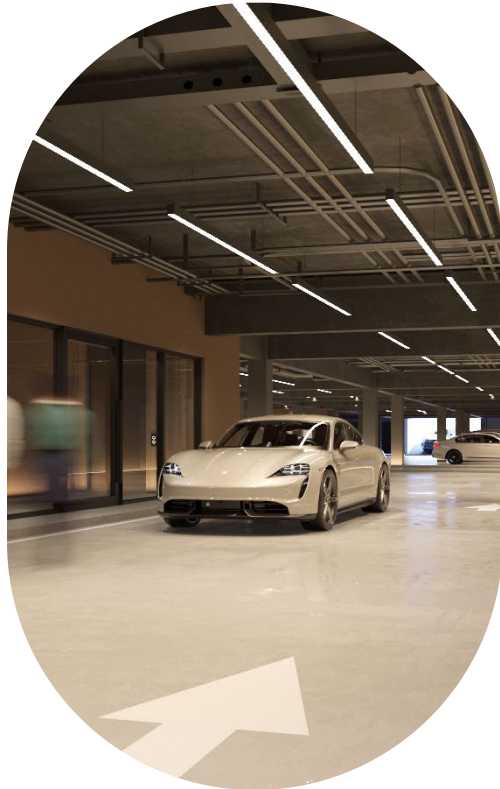





Bayahibe offers an unforgettable experience for visitors seeking adventure and natural beauty.

Here are some activities and their approximate travel times from Bayahibe:



10' MIN

ESTE NATIONAL
PARK COTIBANAMÁ

by car



40' MIN

SAONA ISLAND

By boat from the
Bayahibe bay



15' MIN

LA ROMANA
AIRPORT

by car



10' MIN

PADRE NUESTRO
CAVES

by car



40' MIN

PUNTA CANA
AIRPORT

by car



10' MIN

BEACH &
RESTAURANTS

by car





All renders/images shown are for illustrative purposes only.



3 buildings



88 apartments



Curved terraces
and sinuous shapes

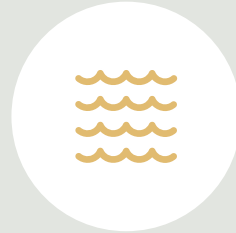

Evokes the ocean
waves

A VISUAL FUSION

Each building is equipped with elevators and features ceilings clad in synthetic wood, adding warmth and elegance to the overall design.



LE NID



All renders/images shown are for illustrative purposes only.



Technical **FEATURES**

THE BUILDING

The building has pressurized metastasis vision of water that uses impulse pumps and fire reserve tanks.

In addition, extinguishing is available as well as hoses and hoses for emergency cases. The project will have a gas pipelines system.

The building electricity is supplied by the Bayahibe energy consortium. In case of any light outs, it has emergency lights that use Self-recharging lamps are used in the stairwell and lobby areas.

THE APARTMENTS

The apartments offer equipped units with air conditioning in the rooms and pre-installation of air conditioning in the living room, floors and bathroom coverings in porcelain similar to travertine, aluminum windows P92 or higher.

In addition, they count the number of bathrooms and quartz kitchen, kitchen and bathroom furniture, melamin water-repellent, European faucets, built-in gas stoves, doors and closets with water-repellent melamine and top-quality hardware.



LE NID

All renders/images shown are for illustrative purposes only.



A high-quality investment
PAYMENT OPTIONS

		Initial payment	Construction	Final payment
Paying Soon	7% discount	90%	0%	10%
Paying Soon 50%	5% discount	50%	30%	20%
Standard Payment	2000 USD	25%	45%	30%
	Booking	The signing of this contract will take place		Upon delivery



All renders/images shown are for illustrative purposes only.



All renders/images shown are for illustrative purposes only.



All renders/images shown are for illustrative purposes only.



LE NID



PLANS

Norte del proyecto



Proyecto:

LE NID

Bayahibe, La Altagracia
República Dominicana

Propietario:

Leyenda

- 01 Lobby bloque B
- 02 Bloque A
- 03 Bloque C
- 04 Area común
- 05 Deck piscina
- 06 Piscina
- 07 Gazebo común
- 08 Jardín
- 09 Acceso parqueos sótano
- 10 Acceso peatonal

Equipo de trabajo

Diseño Arquitectónico:

Arq. Frederick Cedano

Codia:

Arq. Colaboradores:

Arq. Gabriela Moreno

Plano

PLANTA DE CONJUNTO
LE NID

A103

Escala

1 : 250

Fecha:

AGOSTO
2024

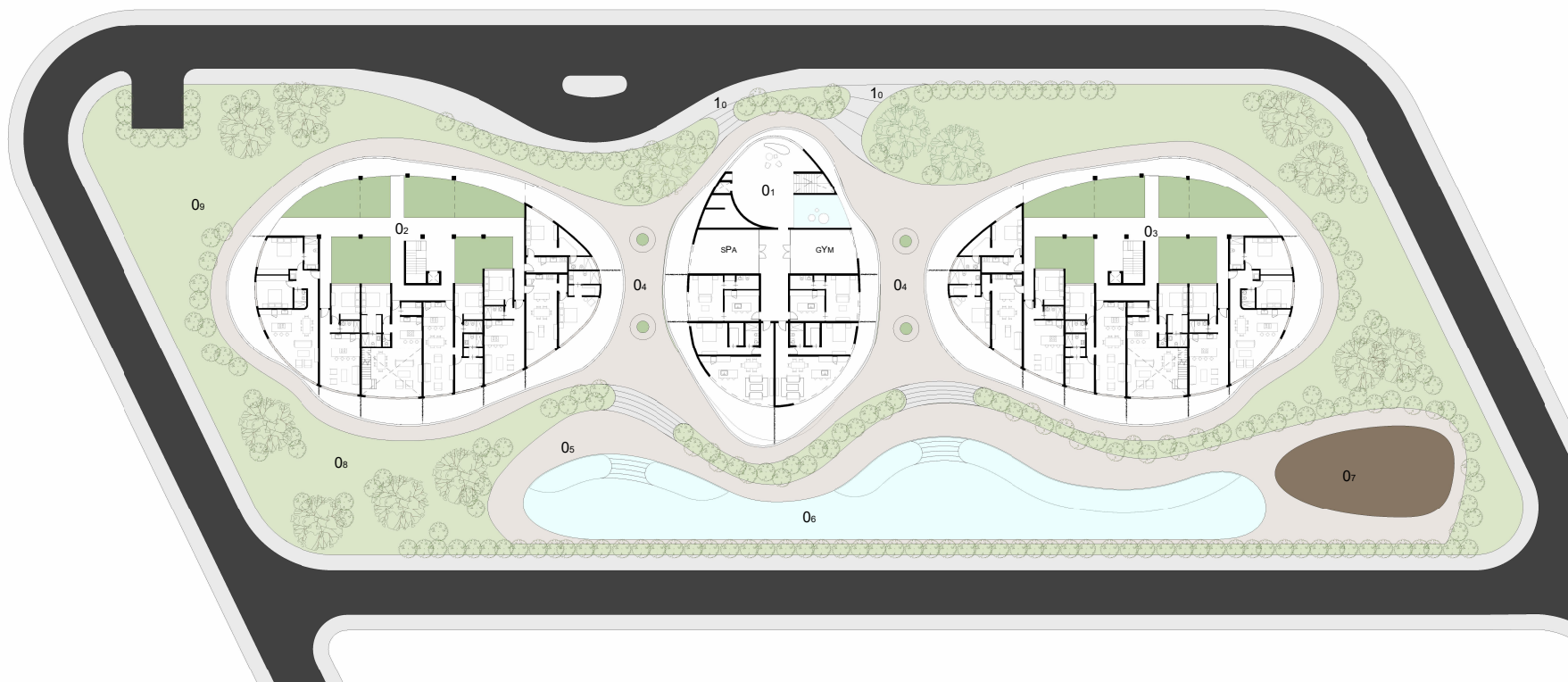

PLANTA DE CONJUNTO
BLOQUES A, B Y C

① PLANTA DE CONJUNTO
1 : 250